



# Establishment of a New and Modern Oncology and Hematology Outpatient Center at the Hillel Yaffe Medical Center



**Hillel Yaffe**  
Medical Center  
People are Our Speciality



המרכז הרפואי  
**הלל יפה**  
עמותת הידידים



# The Oncology Outpatient unit - The Current Situation

The oncology unit at the Hillel Yaffe Medical Center opened in December 2012, in light of the huge demand for oncology treatment at the hospital. The unit, run by Dr. Valerya Semenisty, is comprised of only 6 inpatient beds (in the department) and 13 outpatient treatment stations.

**Most of the activity of the oncology unit is carried out through the Outpatient oncology unit.**

The unit staff includes physicians specializing in clinical oncology, certified nurses with extensive expertise and experience in the oncology field, a social and administrative service team, a psychologist and a dietitian.

The unit provides a variety of services that include: follow-up and counseling, chemotherapy, biologic therapy and immunotherapy, palliative care (supportive care to improve quality of life for terminally ill patients), blood and fluid delivery, pain and symptom management, innovative treatments with advanced drugs (in clinical trials). In addition, comprehensive support services are provided that include: psychological guidance and support for the patients and their families, activities for the patients' well-being such as: physical activity, complementary therapies and more.

The number of patients seeking treatment has steadily increased every year. The growing awareness of cancer, the increase in the number of patients due in part to the increase in the population served by the hospital and the search for treatment close to the area of residence, has led to a 40% increase in the number of patients since the unit opened. In 2020, the unit treated about 5,000 cancer patients in a large array of treatments.

**Despite the huge increase in the number of patients and expectations for further increase, the number of treatment stations and the size of the oncology day unit have not changed since it opened. The oncology day hospital complex, which currently includes only 13 treatment stations, is very crowded (it is only about 200 square meters with no windows). It does not meet the current needs, both in the number of treatment stations and in hospital conditions for patients and their families. It is extremely crowded and without a proper and comfortable space for the attendant, who is very much needed to assist oncology patients.**

These conditions, and the lack of any other large and comprehensive oncology unit 50 km both north and south of the hospital, necessitate the establishment of a new, spacious and modern day oncology hospital unit that will enable residents of the area suffering from cancer, to receive advanced and life-saving medical care. And near their place of residence.



# The Hematology Institute - The Current Situation

The Hematology Institute (including hemato-oncology) is directed by Dr. Orit Sofer. The institute provides a variety of treatments to patients, especially through its day hospital unit, and also provides support and advice to all hospital departments including the emergency department. The unit staff includes specialist physicians, certified nurses with extensive expertise and experience in the field of hematology and hemato-oncology.

The Hematology Institute provides a variety of comprehensive services that include: treatment and follow-up of chronic patients with blood diseases such as anemia and clotting as well as patients treated in the day hospital through blood transfusions, chemotherapy treatments and other intravenous medications.

**As part of the institute's activities, hemo-oncological treatments are given to cancer patients suffering from a variety of malignant diseases, including leukemia, myeloma and lymphoma.**

**The number of patients applying for treatment at the Hematology Institute is steadily increasing every year.**

The quality of treatment and the variety of problems it treats, the increase in the number of patients, the increase in the population of the area and the need

for treatment close to the patients' residence, has led to an increase of about 20% in number of patients treated in 2020, compared to 2019.

In 2020, about 8,200 patients were treated, and about 2,300 of them were cancer patients who received chemotherapy infusions. Despite the continuing growth in the number of patients, the conditions currently prevailing in the Hematology Institute are not suited to the needs of both the patients and their family members and the medical staff. The institute currently includes 21 treatment stations which are spread over an area of only about 400 square meters.

**The institute is very crowded, does not include isolation rooms for patients with poor immune systems (to reduce exposure to life-threatening infections), there is a shortage of examination rooms and therefore some of the tests are performed in a central treatment space with only a curtain providing privacy. In addition, there are no dedicated rooms for psychological services, a social worker, spiritual guidance etc. for patients and their families.**

These conditions make it very difficult for both patients and family members and for the medical staff to do their utmost to provide the most professional and advanced medical care.

The Hematology Institute is a central institute for residents of the area. Existing conditions in the institute do not meet required needs and necessitate the establishment of a new, spacious and modern Hematological Institute for the well-being of patients, family members and medical staff.

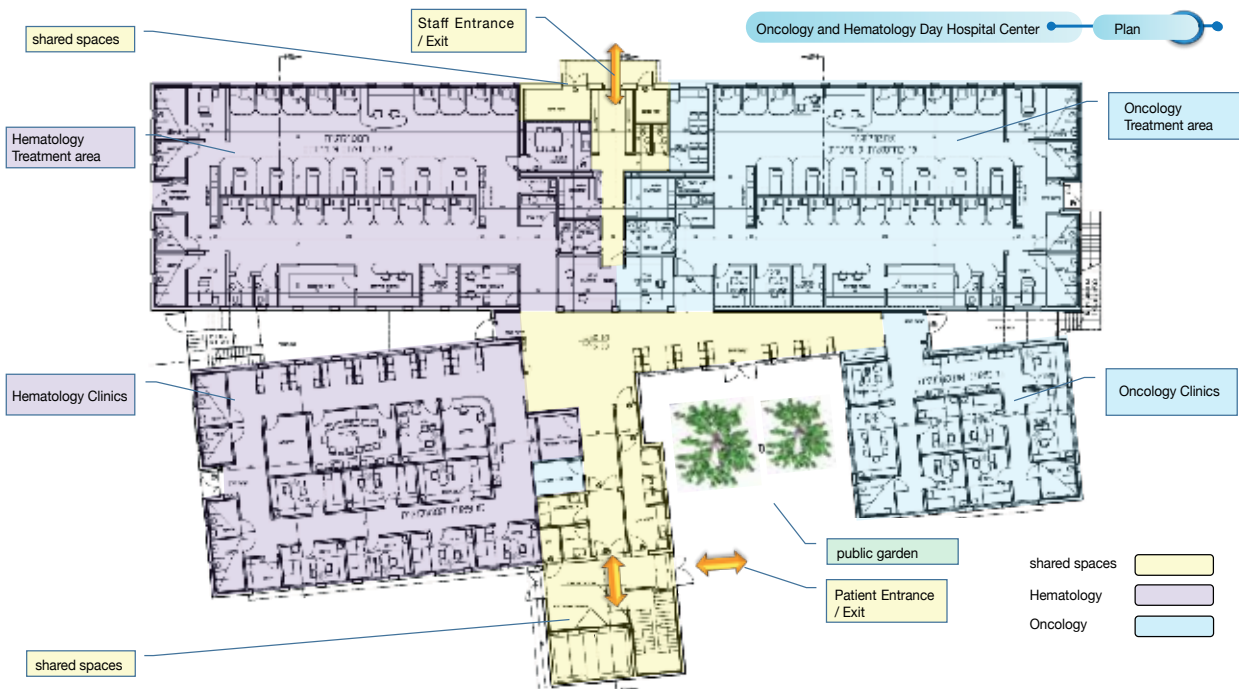

## The Objective - The Establishment of a New and Modern Oncology and Hematology Outpatient Center

We are interested in establishing a new, spacious and modern Outpatient Center that will put the oncological and hematological treatments under one roof. The center will enable us to provide patients with the most comprehensive and highest quality medical care, under modern hospitalization conditions and with the maximum comfort required by their medical conditions.

**During 2021, the construction of a new and modern building was completed at the hospital. This new building contains 2 floors, with the first floor intended for an oncology and hematology Outpatient Center. The new center will be spread over one floor in an area of about 1,800 square meters (3 times the existing situation) and will be divided into two areas - oncology and hematology.**

It was specifically designed with the aim of providing the best response to the medical needs of the patients, the services that accompany their treatment, accessibility for the patients, convenience of treatment, and the comfort of the accompanying families and the medical staff.

### Oncology Day Hospitalization:

It will cover an area of about 670 square meters and will include:

- 26 spacious and modern treatment stations - 19 lounge chairs and 7 beds
- 2 isolation rooms
- 6 examination rooms
- Reception desk, nurse's station, social worker office, psychologist office, drug storage room, staff room, etc.

### Hematology Institute:

It will cover an area of about 830 square meters and will include:

- 25 spacious and modern treatment stations - 18 lounge chairs and 7 beds
- 2 isolation rooms
- 4 examination rooms
- Nurse's station, social worker office, drug storage room, etc.

The center will be equipped with the most advanced medical equipment, comfortable and personal treatment stations, suitable for lengthy treatment (sitting and lying down), advanced examination rooms and everything required for both medical care and the comfort of the patient and family.

The two complexes will be comprised of the 2 units and common areas of about 250 square meters that will include a pleasant and comfortable waiting area for accompanying families, a calming green patio that will enable patients and family members to wait in a peaceful space, etc.

# The New Oncology and Hematology Outpatient Center – Images



\*Images are for illustration purposes only

## Costs

In order to open the new center as soon as possible, interior construction must be made to adapt to the requirements of the center and increase in the number of treatment stations.

**The total cost of construction and equipment is approximately NIS 8,000,000:**

- The cost of internal construction changes is approximately NIS 4,500,000
- The cost of medical equipment and furniture is approximately NIS 3,500,000

## Funding:

The hospital will cover about NIS 4.5 million and the balance, in the amount of about NIS 3.5 million, is expected to be provided through the Hospital's Friends Association.

## Schedule:

The Center (including interior construction, medical equipment and furnishing) is expected to be completed by the end of 2022.

## The Request

Oncology patients and patients with hematological diseases needing ongoing and life-saving treatment, must to receive it with the highest level of accessibility, close to their places of residence and under the most comfortable conditions for both them and their accompanying families.

We are interested in providing the many patients in our area with the most advanced medical care and giving them the highest chances of recovery.

**We turn to you in the hope that you will recognize the importance of this project and the need to respond by helping us and making a donation.**

### To donate by bank transfer:

Friends of Hillel Yaffe Medical Center  
Bank Leumi, Hadera branch 953  
Account Number: 48590094

### For credit card donations:

The barcode must be scanned



**All donations are recognized for tax purposes under Section 46 of the Income Tax Ordinance.**

For further details:

Dikla Rosenfeld 04-7748317, 052-6157221, Email: diklar@hymc.gov.il